

Building Envelope Innovations, LLC

Wet-Flash® PM-7000

Liquid Applied Flashing System

1. PRODUCT NAME

Liquid-Applied Flashing and Waterproofing Membrane; BEI® PM-7000 Wet-Flash System

2. MANUFACTURER

Building Envelope Innovations, LLC
14755 SE 82nd Drive
Clackamas, OR. 97015
Phone: (503) 972-2305
www.wet-flash.com

3. PRODUCT DESCRIPTION

Wet-Flash PM-7000 is a 99% solids, single-component, elastomeric, liquid applied coating/sealant, exhibiting the combined benefits of silicone and urethane.

PM 7000 reacts with atmospheric moisture to form a continuous membrane that is waterproof, breathable, flexible and allows for an airtight installation of windows, doors and other thru-wall penetrations and flashing applications

Wet-Flash PM 7000 is based on silyl-terminated polyether polymers filled with environmentally safe pigments for body and color.

Additives include a fungicide to inhibit mold growth, adhesion promoters that allow application to damp substrates of most construction materials.

Typical Uses: BEI® PM-7000 Wet-Flash System is designed for:

- Waterproofing Cavity Walls, Window/Door openings and other thru-wall components
- Both Horizontal and Vertical Surfaces
- Both Interior and Exterior Surfaces



Limitations:

BEI PM 7000 should not be applied if temperatures are expected to be lower than 40F within 24 hours of application or when surface temperatures are greater than 110F.

PM 7000 is not intended for below grade applications.

PM 7000 is not intended for direct exposure to UV for longer than 6 months.

4. TECHNICAL DATA

These values are not intended for use in preparing specifications.

Cured Properties

Hardness, Shore A	40-45
Tensile Strength	180 Psi
Elongation at Break	400%
Peel Strength	25pli
Accelerated weathering	passes
Staining	passes
Corrosive Properties	Non-corrosive

Uncured Properties

Tack Free Time	<30 minutes
Cure Rate	3/16 inch/24 hours
Volatile Organic Content	1.5% by weight
	27 g/Lt .2 lbs/Gal.
Water Vapor Transmission	26.7 US Perms

Specification Writers: Please contact BEI Corporation, Clackamas, Oregon, before writing specifications on this product.

4. TECHNICAL DATA *Continued* Applicable Standards

ASTM E-331 Water resistance
ASTM E-283 Air infiltration
ASTM D-2240 Shore Hardness
ASTM D-2370 Elongation/Tensile
ASTM E-96 Vapor Transmission
Other test data and results available upon request from manufacturer.

5. INSTALLATION

As a window opening installation procedure using sheet type WRB: See diagram #1

As with any installation method, the rough opening must be prepared by ensuring that it is plumb, square, and dimensionally correct. It should also be smooth cut, clean and dry, with the sheathing trimmed properly to support the window frame and ensure long-term structural integrity of the exterior construction wall.

Apply PM-7000 liquid applied flashing membrane (#1 in diagram 1) to bottom of opening and out 9 inches to side of opening at lower portion of opening at 12 mils thickness. Do not apply material to sheathing below rough opening.

PM-7000 is packaged in cartridges or bulk to be applied with standard caulk tools, then brushed, rolled, or trowel to desired coating thickness.

While PM-7000 is still wet, install pre-creased fabric counter-flashing (#3 in diagram 1) 3 inches above bottom of opening, extending 9 inches to both sides. Cut textile flashing at sides of opening to the bottom of opening and fold over sill. Press fabric counter-flashing into liquid with broad knife.

Apply PM-7000 to the balance of the rough opening (Areas 1, 2, and 8 of the diagram 1), over fabric counter-flashing at sill and out 9 inches at sides and top of opening. PM-7000 will not be transparent when applied at the correct thickness of 12 mils.

After PM-7000 has dried to the touch (15-30 minutes), the opening is ready for window installation but can be Exposed to weather for extended periods without damage. Install window, with drainage mesh (or shims) at bottom flange to allow for water management.

Push closed-cell foam backer rod (#5 in diagram 1) into gap around interior side of window frame to ensure proper depth-to-width ratio.

Apply WS-7100 interior seal (#4 in diagram 1) around entire window frame at interior side of window. Tool uncured sealant with appropriate equipment (spatula) to ensure proper contact with window frame and coated rough opening surfaces.

Method of Application:

BEI's installation method involves coating the window opening with the Wet-Flash, PM-7000 waterproof membrane - permanently bonding to a wide variety of construction materials under most construction site environments. Opaque when applied in the proper thickness of 12 mils, quality control inspection becomes easy.

The window is then sealed to the rough opening on the interior side of the frame with an interior sealant joint using WS-7100. The Wet-Flash, Liquid Applied

Flashing System is incorporated into the weather resistant barrier system allowing any water from wind driven rain or other sources penetrating through leaky windows and siding/trim to exit away from the building via the drainage plane.

Surface Preparation – Apply to clean surfaces free of contaminants that may adversely affect adhesion. Wood or concrete may have high moisture content with no affect on adhesion. Can be rolled, brushed, or trowelled.

Do not apply at < 33F or > 100F. Paint-able with most paints after 2 hours.

Clean equipment before material cures with mineral spirits or other mild solvent.

Coverage: 125 Square feet per gallon at **12 mils thickness.**

Shelf Life: When stored at or below 80 Degrees F BEI PM-7000 Liquid-Applied Flashing has a shelf life of 1 year from date of manufacture.

6. AVAILABILITY AND COST

Availability: BEI PM-7000 and other Wet-Flash products are available from qualified outlets. Contact the manufacturer for the nearest product distributor.

Ordering Information:

Contact Customer Service: Building Envelope Innovations LLC.

503-972-2305

BEI@wet-flash.com

7. WARRANTY

Contact manufacturer for specific warranty information

8. MAINTENANCE

None required

9. TECHNICAL SERVICES

Contact manufacturer for availability.

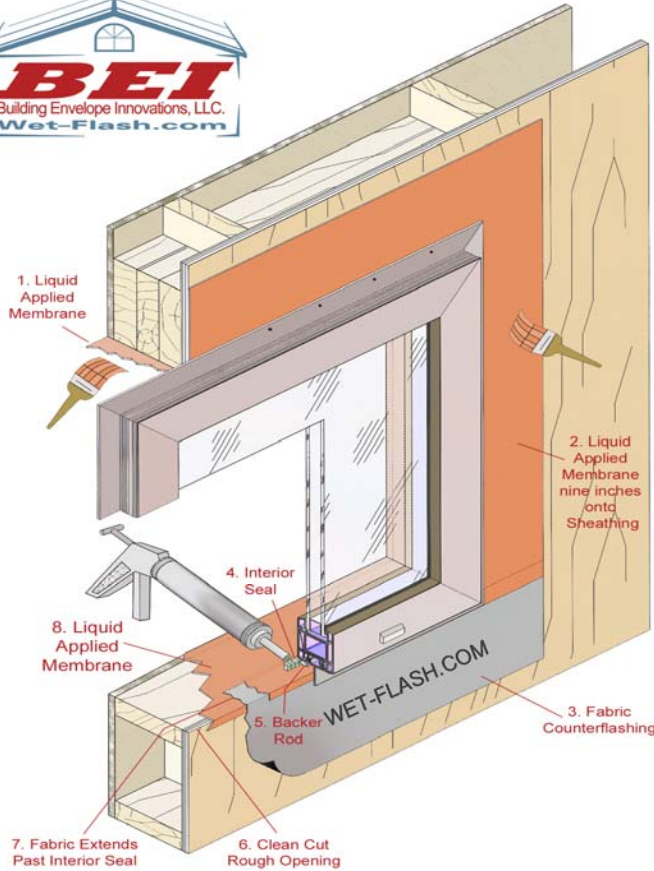

U.S. FIELD SALES OFFICES

Clackamas, OR

Building Envelope Innovations, LLC.
14755 SE 82nd Drive
Clackamas, OR 97015
Phone: (503) 972-2305

Seattle, WA

Building Envelope Innovations, LLC.
1115 N. 97th Street
Seattle, WA 98103
(206) 985-3788

Orlando, FL

Building Envelope Innovations, LLC
133 Margate Mews
Longwood, FL 32779
(407) 222-7672

DIAGRAM 1: Installation method, which protects the Rough Opening (RO) from moisture and air intrusion.

Please note:

Application is not limited to the materials shown in the diagram and include Metal framing, exterior gypsum, CMU and most other construction materials.

The information and data contained herein are based on information we believe reliable. You should thoroughly test any application and independently conclude satisfactory performance before commercialization. Suggestions of uses should not be taken as inducements to infringe any particular patent.

MSDS INFORMATION

ATTENTION: PRODUCT SAFETY INFORMATION REQUIRED FOR SAFE USE IS NOT INCLUDED. BEFORE HANDLING, READ PRODUCT AND MATERIAL SAFETY DATA SHEETS AND CONTAINER LABELS FOR SAFE USE, PHYSICAL AND HEALTH HAZARD INFORMATION. THE MATERIAL SAFETY DATA SHEET IS AVAILABLE FROM YOUR BEI REPRESENTATIVE, OR DISTRIBUTOR, OR BY WRITING TO BEI CUSTOMER SERVICE, OR BY CALLING (503) 972-2305.

BUILDING ENVELOPE INNOVATIONS, LLC.
CLACKAMAS, OREGON 97015

“Wet-Flash“ is a trademark of BEI Corporation.

